

## MK ŞAFT ÖLÇÜLERİ

DIN 228A -ÇEKTİRMELİ

DIN 2207

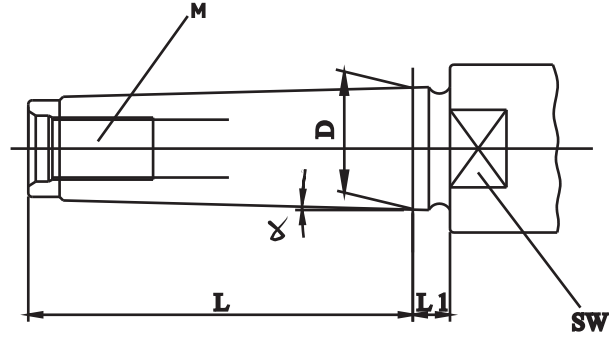

MK	α	D	L	L1	SW	M
2	1°25'50"	17,780	64	5	-	M10
3	1°26'16"	23,825	81	5	24	M12
4	1°29'15"	31,267	102,5	6,5	32	M16
5	1°30'26"	44,399	129,5	6,5	45	M20

DIN 228 B -KAMALI

DIN 1806

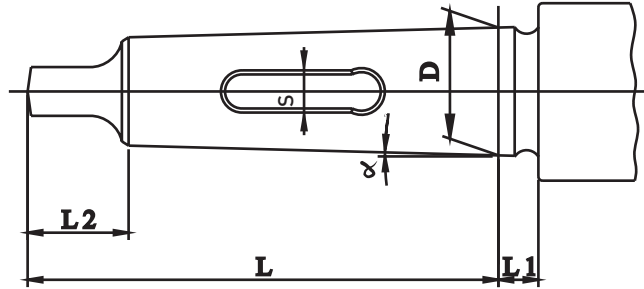

MK	α	D	L	L1	S
2	1°25'50"	17,780	75	5	-
3	1°26'16"	23,825	94	5	8,3
4	1°29'15"	31,267	117,5	6,5	8,3
5	1°30'26"	44,399	149,5	6,5	12,4

- MALZEME: ALAŞIMLI SEMENTE ÇELİĞİ- min. 900 N/mm<sup>2</sup>
- SERTLİK 56-60 HRC/ SERTLİK DERİNLİĞİ 0,6-0,9 mm
- AÇI HASSASİYETİ: DIN 7178-1 / AT3