

## HAVALI VALFLER VE CİVATA ÇEŞİTLERİ

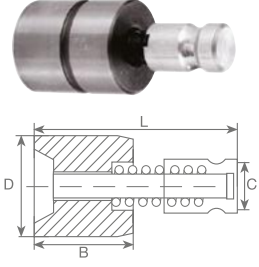

## HAVALI VALFLER

## STANDART TİP



Sip. No.	D	B	C	L
HİV 8	8	10	6	27
HİV 10	10	11	6	29
HİV 12	12	11	8	29
HİV 16	16	20	8	42
HİV 18	18	20	12	42
HİV 20	20	20	12	46
HİV 25	25	20	12	62

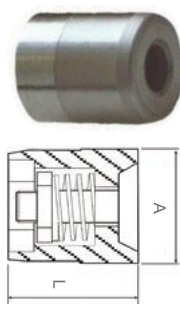

## MİNİ TİP

Sip. No.	A	L
HİVM 6	6	12
HİVM 8	8	12
HİVM 10	10	12
HİVM 12	12	12
HİVM 16	16	20

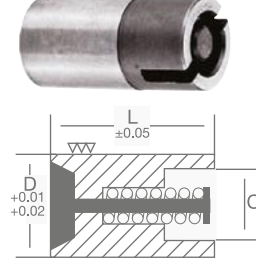

## JET TİP

Sip. No.	D	C	L
HİJ 6	6	4	12
HİJ 8	8	4.5	15
HİJ 10	10	6	20
HİJ 12	12	8	25
HİJ 16	16	10	30
HİJ 18	18	12	30
HİJ 20	20	12	30
HİJ 25	25	15	30

## İMBUS CİVATA ÇEŞİTLERİ

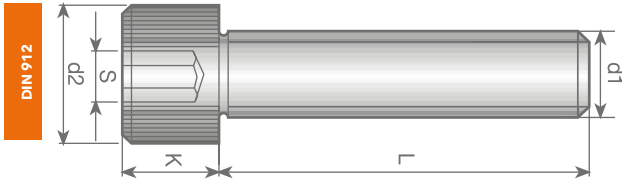

8,8 - 12,9 Kalite



d1	d2	K	S	L
M3	5.5	3	2.5	10 12 15 20 25 30 35 40 45 50 55 60 70 80 90 100 110 120 130 140 150 160 170 180 190 200 220 240 260 280 300 320 340 360 380 400
M4	7	4	3	10 12 15 20 25 30 35 40 45 50 55 60 70 80 90 100 110 120 130 140 150 160 170 180 190 200 220 240 260 280 300 320 340 360 380 400
M5	8.5	5	4	10 12 15 20 25 30 35 40 45 50 55 60 70 80 90 100 110 120 130 140 150 160 170 180 190 200 220 240 260 280 300 320 340 360 380 400
M6	10	6	5	10 12 15 20 25 30 35 40 45 50 55 60 70 80 90 100 110 120 130 140 150 160 170 180 190 200 220 240 260 280 300 320 340 360 380 400
MB	13	8	6	10 12 15 20 25 30 35 40 45 50 55 60 70 80 90 100 110 120 130 140 150 160 170 180 190 200 220 240 260 280 300 320 340 360 380 400
M10	16	10	8	10 12 15 20 25 30 35 40 45 50 55 60 70 80 90 100 110 120 130 140 150 160 170 180 190 200 220 240 260 280 300 320 340 360 380 400
M12	18	12	10	10 12 15 20 25 30 35 40 45 50 55 60 70 80 90 100 110 120 130 140 150 160 170 180 190 200 220 240 260 280 300 320 340 360 380 400
M14	21	14	12	10 12 15 20 25 30 35 40 45 50 55 60 70 80 90 100 110 120 130 140 150 160 170 180 190 200 220 240 260 280 300 320 340 360 380 400
M16	24	16	14	10 12 15 20 25 30 35 40 45 50 55 60 70 80 90 100 110 120 130 140 150 160 170 180 190 200 220 240 260 280 300 320 340 360 380 400
M18	27	18	14	10 12 15 20 25 30 35 40 45 50 55 60 70 80 90 100 110 120 130 140 150 160 170 180 190 200 220 240 260 280 300 320 340 360 380 400
M20	30	20	17	10 12 15 20 25 30 35 40 45 50 55 60 70 80 90 100 110 120 130 140 150 160 170 180 190 200 220 240 260 280 300 320 340 360 380 400
M24	36	24	19	10 12 15 20 25 30 35 40 45 50 55 60 70 80 90 100 110 120 130 140 150 160 170 180 190 200 220 240 260 280 300 320 340 360 380 400
M30	45	30	22	10 12 15 20 25 30 35 40 45 50 55 60 70 80 90 100 110 120 130 140 150 160 170 180 190 200 220 240 260 280 300 320 340 360 380 400

## SETSKUR CİVATA

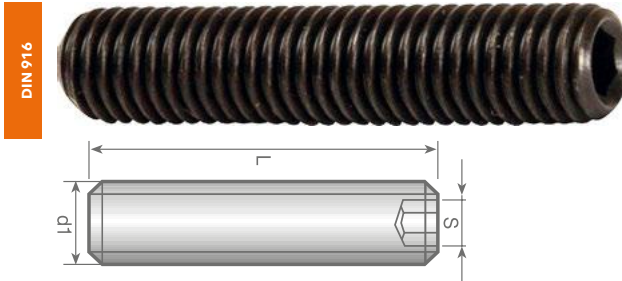

12,9 Kalite

d1	S	L
M3	1.5	10 15 20 25 30 35 40 50 60
M4	2	10 15 20 25 30 35 40 50 60
M5	2.5	10 15 20 25 30 35 40 50 60
M6	3	10 15 20 25 30 35 40 50 60
MB	4	10 15 20 25 30 35 40 50 60
M10	5	10 15 20 25 30 35 40 50 60
M12	6	10 15 20 25 30 35 40 50 60
M14	6	10 15 20 25 30 35 40 50 60
M16	8	10 15 20 25 30 35 40 50 60

## HAVŞA BAŞLI CİVATA



10,9 Kalite

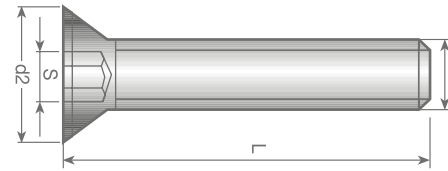

d1	d2	S	L
M3	6	2	10 15 20 25 30 35 40 50 60
M4	8	2.5	10 15 20 25 30 35 40 50 60
M5	10	3	10 15 20 25 30 35 40 50 60
M6	12	4	10 15 20 25 30 35 40 50 60
MB	16	5	10 15 20 25 30 35 40 50 60
M10	20	6	10 15 20 25 30 35 40 50 60
M12	24	8	10 15 20 25 30 35 40 50 60
M16	30	10	10 15 20 25 30 35 40 50 60