

KALIP ELEMENLARI

GAZ ATMA FİLTRESİ

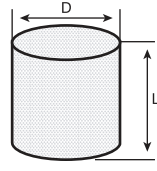

Sip. No.	D	L
PGF 2	2mm	5,0
PGF 3	3mm	10,0
PGF 4	4mm	10,0
PGF 5	5mm	10,0
PGF 6	6mm	10,0
PGF 8	8mm	10,0
PGF 10	10mm	10,0
PGF 12	12mm	12,0
PGF 15	15mm	10,0
PGF 16	16mm	10,0

GAZ ATMA FİLTRESİ (SİNERLİ)

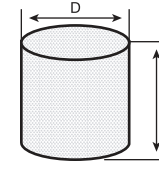

Sip. No.	D	L
SGF 3	3mm	10,0
SGF 4	4mm	10,0
SGF 5	5mm	10,0
SGF 6	6mm	10,0
SGF 8	8mm	10,0
SGF 10	10mm	10,0
SGF 12	12mm	12,0
SGF 15	15mm	10,0

GAZ ATMA FİLTRESİ (KANALLI)

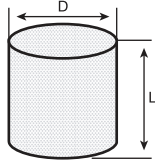

Sip. No.	D	L
KGF 6	6mm	10,0
KGF 8	8mm	10,0
KGF 10	10mm	10,0
KGF 12	12mm	10,5

GAZ ATMA FİLTRESİ (ÇELİK SİNERLİ)

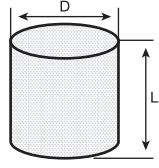

Çsgf	D	L
Çsgf 4	4mm	10,0
ÇSGF 6	6mm	10,0
ÇSGF 8	8mm	10,0
ÇSGF 10	10mm	12,0
ÇSGF 12	12mm	12,0
ÇSGF 16	16mm	14,0
ÇSGF 20	20mm	15,0
ÇSGF 28	28mm	15,0

TAŞIYICI SONSUZ SAPAN



Düz kaldırma kapasitesi (WLL)	Sonsuz Halat Uzunlukları (L1) m					
	2m	3m	4m	5m	6m	8m
1.000 kg	•	•	•	•	•	•
2.000 kg	•	•	•	•	•	•
3.000 kg	•	•	•	•	•	•
4.000 kg	•	•	•	•	•	•
5.000 kg	•	•	•	•	•	•
6.000 kg	•	•	•	•	•	•
8.000 kg	•	•	•	•	•	•
10.000 kg	•	•	•	•	•	•

TAŞIYICI SAPAN

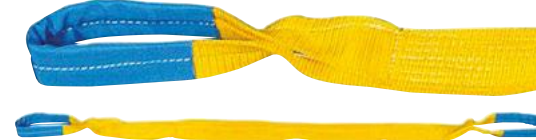

Düz kaldırma kapasitesi (WLL)	Sonsuz Halat Uzunlukları (L1) m					
	2m	3m	4m	5m	6m	8m
1.000 kg	•	•	•	•	•	•
2.000 kg	•	•	•	•	•	•
3.000 kg	•	•	•	•	•	•
4.000 kg	•	•	•	•	•	•
5.000 kg	•	•	•	•	•	•
6.000 kg	•	•	•	•	•	•

ERKEK AYBOLD (MAPA)

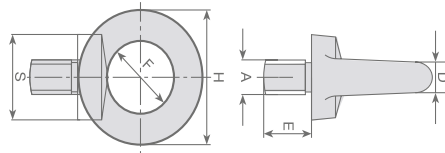

A	D	E	F	H	S	g	Kaldırma Kap.(kg)
M10	10	18	25	45	25	110	230
M12	12	22	30	54	30	195	340
M14	12	22	30	54	30	205	460
M16	14	28	35	63	35	325	700
M18	14	28	35	63	35	335	850
M20	16	30	40	72	40	505	1200
M24	20	38	50	90	50	1020	1800
M30	24	45	60	108	65	1850	3600
M36	28	55	70	126	75	2700	5100
M42	32	65	80	135	85	4030	7000
M56	42	78	100	184	110	8800	11500
M64	48	90	110	206	120	12400	16500

FIRDÖNDÜLÜ MAPA

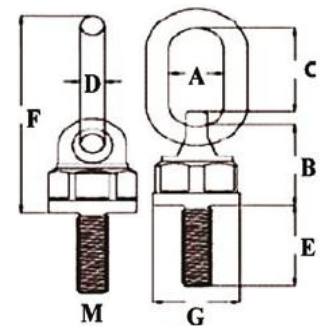

Çap	WLL(kg)	Ana Teknik Parametreler (mm)							Ağırlık
		A	B	C	D	E	F	G	
M10	500	28.6	39.0	31.8	7.90	19.0	85.8	36.0	0.27
M12	1050	35.0	67.0	58.0	12.7	19.1	149.8	60.0	1.20
M16	1200	35.0	67.0	58.0	12.7	31.8	149.8	60.0	1.20
M20	1900	40.0	78.3	67.0	19.1	38.1	178.7	70.0	2.21
M24	2150	40.0	78.3	67.0	19.1	38.1	178.7	70.0	2.21
M30	5000	51.6	93.1	95.0	22.2	50.0	227.4	80.0	3.86
M36	8000	51.6	93.1	95.0	22.2	54.0	227.4	80.0	3.86
M42	10000	65.0	103.7	118	25.0	63.0	265.8	93.0	6.08