

HSS HAVŞA BAŞLI ZIMBA

HSS / YÜKSEK HIZ ÇELİĞİ ZIMBA

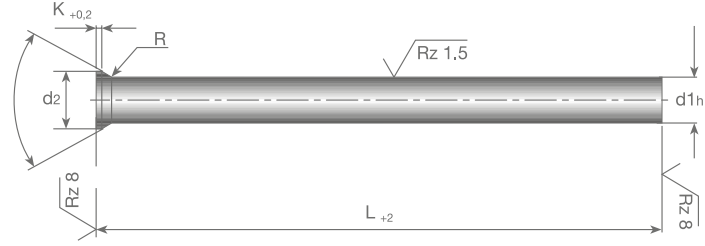

- Malzeme : 1.3343
- Sertlik : Gövde 60/62 HRC Kafa 45+5 HRC
- Yüzey : Sertleştirilmiş, taşlanmış.



Sip. No.	d1	d2	K (0,2)	L2	Sip. No.	d1	d2	K (0,2)	L2	Sip. No.	d1	d2	K (0,2)	L2	Sip. No.	d1	d2	K (0,2)	L2
DZHK0.571			0.2	71	DZHK2.471				71	DZHK3.771				71	DZHK5.071				71
DZHK0.580	0.5	0.9		80	DZHK2.480				80	DZHK3.780				80	DZHK5.080				80
DZHK0.5100				100	DZHK2.4100	2.4			100	DZHK3.7100	3.7			100	DZHK5.0100	5			100
DZHK0.671				71	DZHK2.4125				125	DZHK3.7125				125	DZHK5.0125				125
DZHK0.680	0.6	1.1		80	DZHK2.4160				160	DZHK3.7160				160	DZHK5.0160				160
DZHK0.6100				100	DZHK2.571				71	DZHK3.871				71	DZHK5.171				71
DZHK0.771				71	DZHK2.580				80	DZHK3.880				80	DZHK5.180				80
DZHK0.780	0.7	1.3		80	DZHK2.5100	2.5			100	DZHK3.8100	3.8	5		100	DZHK5.1100	5.1			100
DZHK0.7100				100	DZHK2.5125				125	DZHK3.8125				125	DZHK5.1125				125
DZHK0.871				71	DZHK2.5160				160	DZHK3.8160				160	DZHK5.1160				160
DZHK0.880	0.8	1.4	0.4	80	DZHK2.671				71	DZHK3.971				71	DZHK5.271				71
DZHK0.8100				100	DZHK2.680				80	DZHK3.980				80	DZHK5.280				80
DZHK0.971				71	DZHK2.6100	2.6			100	DZHK3.9100	3.9			100	DZHK5.2100	5.2	6.5		100
DZHK0.980	0.9	1.6		80	DZHK2.6125				125	DZHK3.9125				125	DZHK5.2125				125
DZHK0.9100				100	DZHK2.6160				160	DZHK3.9160				160	DZHK5.2160				160
DZHK1.071				71	DZHK2.771				71	DZHK4.071				71	DZHK5.371				71
DZHK1.080	1			80	DZHK2.780				80	DZHK4.080				80	DZHK5.380				80
DZHK1.0100				100	DZHK2.7100	2.7			100	DZHK4.0100	4			100	DZHK5.3100	5.3			100
DZHK1.171				71	DZHK2.7125				125	DZHK4.0125				125	DZHK5.3125				125
DZHK1.180	1.1			80	DZHK2.7160				160	DZHK4.0160				160	DZHK5.3160				160
DZHK1.1100				100	DZHK2.871				71	DZHK4.171				71	DZHK5.471				71
DZHK1.271				71	DZHK2.880				80	DZHK4.180				80	DZHK5.480				80
DZHK1.280	1.2			80	DZHK2.8100	2.8			100	DZHK4.1100	4.1			100	DZHK5.4100	5.4			100
DZHK1.2100				100	DZHK2.8125				125	DZHK4.1125				125	DZHK5.4125				125
DZHK1.371				71	DZHK2.8160				160	DZHK4.1160				160	DZHK5.4160				160
DZHK1.380	1.3			80	DZHK2.971				71	DZHK4.271				71	DZHK5.571				71
DZHK1.3100				100	DZHK2.980				80	DZHK4.280				80	DZHK5.580				80
DZHK1.471				71	DZHK2.9100	2.9			100	DZHK4.2100	4.2	5.5		100	DZHK5.5100	5.5			100
DZHK1.480	1.4			80	DZHK2.9125				125	DZHK4.2125				125	DZHK5.5125				125
DZHK1.4100				100	DZHK2.9160				160	DZHK4.2160				160	DZHK5.5160				160
DZHK1.571				71	DZHK3.071				71	DZHK4.371				71	DZHK5.671				71
DZHK1.580	1.5			80	DZHK3.080				80	DZHK4.380				80	DZHK5.680				80
DZHK1.5100				100	DZHK3.0100	3	0.5		100	DZHK4.3100	4.3	0.5		100	DZHK5.6100	5.6	0.5		100
DZHK1.671				71	DZHK3.0125				125	DZHK4.3125				125	DZHK5.6125				125
DZHK1.680	1.6			80	DZHK3.0160				160	DZHK4.3160				160	DZHK5.6160				160
DZHK1.6100				100	DZHK3.171				71	DZHK4.471				71	DZHK5.771				71
DZHK1.771				71	DZHK3.180				80	DZHK4.480				80	DZHK5.780				80
DZHK1.780	1.7			80	DZHK3.1100	3.1			100	DZHK4.4100	4.4			100	DZHK5.7100	5.7	7		100
DZHK1.7100				100	DZHK3.1125				125	DZHK4.4125				125	DZHK5.7125				125
DZHK1.871				71	DZHK3.1160				160	DZHK4.4160				160	DZHK5.7160				160
DZHK1.880	1.8			80	DZHK3.271				71	DZHK4.571				71	DZHK5.871				71
DZHK1.8100				100	DZHK3.280				80	DZHK4.580				80	DZHK5.880				80
DZHK1.971				71	DZHK3.2100	3.2	4.5		100	DZHK4.5100	4.5			100	DZHK5.8100	5.8			100
DZHK1.980	1.9			80	DZHK3.2125				125	DZHK4.5125				125	DZHK5.8125				125
DZHK1.9100				100	DZHK3.2160				160	DZHK4.5160				160	DZHK5.8160				160
DZHK2.071				71	DZHK3.371				71	DZHK4.671				71	DZHK5.971				71
DZHK2.080				80	DZHK3.380				80	DZHK4.680				80	DZHK5.980				80
DZHK2.0100	2	3		100	DZHK3.3100	3.3			100	DZHK4.6100	4.6			100	DZHK5.9100	5.9			100
DZHK2.0125				125	DZHK3.3125				125	DZHK4.6125				125	DZHK5.9125				125
DZHK2.0160				160	DZHK3.3160				160	DZHK4.6160				160	DZHK5.9160				160
DZHK2.171				71	DZHK3.471				71	DZHK4.771				71	DZHK6.071				71
DZHK2.180				80	DZHK3.480				80	DZHK4.780				80	DZHK6.080				80
DZHK2.1100	2.1			100	DZHK3.4100	3.4			100	DZHK4.7100	4.7	6		100	DZHK6.0100	6			100
DZHK2.1125				125	DZHK3.4125				125	DZHK4.7125				125	DZHK6.0125				125
DZHK2.1160				160	DZHK3.4160				160	DZHK4.7160				160	DZHK6.0160				160
DZHK2.271				71	DZHK3.571				71	DZHK4.871				71	DZHK6.171				71
DZHK2.280				80	DZHK3.580				80	DZHK4.880				80	DZHK6.180				80
DZHK2.2100	2.2			100	DZHK3.5100	3.5			100	DZHK4.8100	4.8			100	DZHK6.1100	6.1	8		100
DZHK2.2125				125	DZHK3.5125				125	DZHK4.8125				125	DZHK6.1125				125
DZHK2.2160				160	DZHK3.5160				160	DZHK4.8160				160	DZHK6.1160				160
DZHK2.371				71	DZHK3.671				71	DZHK4.971				71	DZHK6.271				71
DZHK2.380				80	DZHK3.680				80	DZHK4.980				80	DZHK6.280				80
DZHK2.3100	2.3	3.5		100	DZHK3.6100	3.6			100	DZHK4.9100	4.9			100	DZHK6.2100	6.2			100
DZHK2.3125				125	DZHK3.6125				125	DZHK4.9125				125	DZHK6.2125				125
DZHK2.3160				160	DZHK3.6160				160	DZHK4.9160				160	DZHK6.2160				160

HSS HAVŞA BAŞLI ZIMBA

HSS / YÜKSEK HIZ ÇELİĞİ ZIMBA



- Malzeme : 1.3343
- Sertlik : Gövde 60/62 HRC Kafa 45+5 HRC
- Yüzeý : Sertleştirilmiş, taşlanmış.

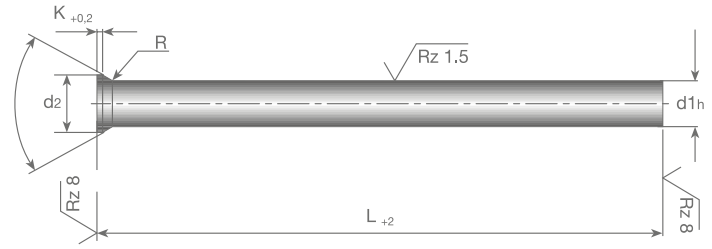

Sip. No.	d1	d2	K (0,2)	L2
DZHK6.371	6.3	8	0.5	71
DZHK6.380				80
DZHK6.3100				100
DZHK6.3125				125
DZHK6.3160				160
DZHK6.471	6.4	8	0.5	71
DZHK6.480				80
DZHK6.4100				100
DZHK6.4125				125
DZHK6.4160				160
DZHK6.571	6.5	8	0.5	71
DZHK6.580				80
DZHK6.5100				100
DZHK6.5125				125
DZHK6.5160				160
DZHK6.671	6.6	8	0.5	71
DZHK6.680				80
DZHK6.6100				100
DZHK6.6125				125
DZHK6.6160				160
DZHK6.771	6.7	8	0.5	71
DZHK6.780				80
DZHK6.7100				100
DZHK6.7125				125
DZHK6.7160				160
DZHK6.871	6.8	8	0.5	71
DZHK6.880				80
DZHK6.8100				100
DZHK6.8125				125
DZHK6.8160				160
DZHK6.971	6.9	8	0.5	71
DZHK6.980				80
DZHK6.9100				100
DZHK6.9125				125
DZHK6.9160				160
DZHK7.071	7	8	0.5	71
DZHK7.080				80
DZHK7.1100				100
DZHK7.0125				125
DZHK7.0160				160
DZHK7.171	7.1	8	0.5	71
DZHK7.180				80
DZHK7.1100				100
DZHK7.1125				125
DZHK7.1160				160
DZHK7.271	7.2	8	0.5	71
DZHK7.280				80
DZHK7.2100				100
DZHK7.2125				125
DZHK7.2160				160
DZHK7.371	7.3	8	0.5	71
DZHK7.380				80
DZHK7.3100				100
DZHK7.3125				125
DZHK7.3160				160
DZHK7.471	7.4	8	0.5	71
DZHK7.480				80
DZHK7.4100				100
DZHK7.4125				125
DZHK7.4160				160

Sip. No.	d1	d2	K (0,2)	L2
DZHK7.571	7.5	8	0.5	71
DZHK7.580				80
DZHK7.5100				100
DZHK7.5125				125
DZHK7.5160				160
DZHK7.671	7.6	8	0.5	71
DZHK7.680				80
DZHK7.6100				100
DZHK7.6125				125
DZHK7.6160				160
DZHK7.771	7.7	8	0.5	71
DZHK7.780				80
DZHK7.7100				100
DZHK7.7125				125
DZHK7.7160				160
DZHK7.871	7.8	8	0.5	71
DZHK7.880				80
DZHK7.8100				100
DZHK7.8125				125
DZHK7.8160				160
DZHK7.971	7.9	8	0.5	71
DZHK7.980				80
DZHK7.9100				100
DZHK7.9125				125
DZHK7.9160				160
DZHK8.071	8	8	0.5	71
DZHK8.080				80
DZHK8.0100				100
DZHK8.0125				125
DZHK8.0160				160
DZHK8.171	8.1	8	0.5	71
DZHK8.180				80
DZHK8.1100				100
DZHK8.1125				125
DZHK8.1160				160
DZHK8.271	8.2	8	0.5	71
DZHK8.280				80
DZHK8.2100				100
DZHK8.2125				125
DZHK8.2160				160
DZHK8.371	8.3	8	0.5	71
DZHK8.380				80
DZHK8.3100				100
DZHK8.3125				125
DZHK8.3160				160
DZHK8.471	8.4	8	0.5	71
DZHK8.480				80
DZHK8.4100				100
DZHK8.4125				125
DZHK8.4160				160
DZHK8.571	8.5	8	0.5	71
DZHK8.580				80
DZHK8.5100				100
DZHK8.5125				125
DZHK8.5160				160
DZHK8.671	8.6	8	0.5	71
DZHK8.680				80
DZHK8.6100				100
DZHK8.6125				125
DZHK8.6160				160

Sip. No.	d1	d2	K (0,2)	L2
DZHK8.771	8.7	8	0.5	71
DZHK8.780				80
DZHK8.7100				100
DZHK8.7125				125
DZHK8.7160				160
DZHK8.871	8.8	8	0.5	71
DZHK8.880				80
DZHK8.8100				100
DZHK8.8125				125
DZHK8.8160				160
DZHK8.971	8.9	8	0.5	71
DZHK8.980				80
DZHK8.9100				100
DZHK8.9125				125
DZHK8.9160				160
DZHK9.071	9	8	0.5	71
DZHK9.080				80
DZHK9.0100				100
DZHK9.0125				125
DZHK9.0160				160
DZHK9.571	9.5	8	0.5	71
DZHK9.580				80
DZHK9.5100				100
DZHK9.5125				125
DZHK9.5160				160
DZHK10.071	10	8	0.5	71
DZHK10.080				80
DZHK10.0100				100
DZHK10.0125				125
DZHK10.0160				160
DZHK10.571	10.5	8	0.5	71
DZHK10.580				80
DZHK10.5100				100
DZHK10.5125				125
DZHK10.5160				160
DZHK11.071	11	8	0.5	71
DZHK11.080				80
DZHK11.0100				100
DZHK11.0125				125
DZHK11.0160				160
DZHK11.571	11.5	8	0.5	71
DZHK11.580				80
DZHK11.5100				100
DZHK11.5125				125
DZHK11.5160				160
DZHK12.071	12	8	0.5	71
DZHK12.080				80
DZHK12.0100				100
DZHK12.0125				125
DZHK12.0160				160
DZHK12.571	12.5	8	0.5	71
DZHK12.580				80
DZHK12.5100				100
DZHK12.5125				125
DZHK12.5160				160
DZHK13.071	13	8	0.5	71
DZHK13.080				80
DZHK13.0100				100
DZHK13.0125				125
DZHK13.0160				160

Sip. No.	d1	d2	K (0,2)	L2
DZHK13.571	13.5	16	1.5	71
DZHK13.580				80
DZHK13.5100				100
DZHK13.5125				125
DZHK13.5160				160
DZHK14.071	14	16	1.5	71
DZHK14.080				80
DZHK14.0100				100
DZHK14.0125				125
DZHK14.0160				160
DZHK14.571	14.5	16	1.5	71
DZHK14.580				80
DZHK14.5100				100
DZHK14.5125				125
DZHK14.5160				160
DZHK15.071	15	16	1.5	71
DZHK15.080				80
DZHK15.0100				100
DZHK15.0125				125
DZHK15.0160				160
DZHK16.071	16	18	1.5	71
DZHK16.080				80
DZHK16.0100				100
DZHK16.0125				125
DZHK16.0160				160
DZHK17.071	17	19	1.5	71
DZHK17.080				80
DZHK17.0100				100
DZHK17.0125				125
DZHK17.0160				160
DZHK18.071	18	20	1.5	71
DZHK18.080				80
DZHK18.0100				100
DZHK18.0125				125
DZHK18.0160				160
DZHK19.071	19	22	1.5	71
DZHK19.080				80
DZHK19.0100				100
DZHK19.0125				125
DZHK19.0160				160
DZHK20.071	20	22	1.5	71
DZHK20.080				80
DZHK20.0100				100
DZHK20.0125				125
DZHK20.0160				160