

DELTA®

D88

DÜZ KAM

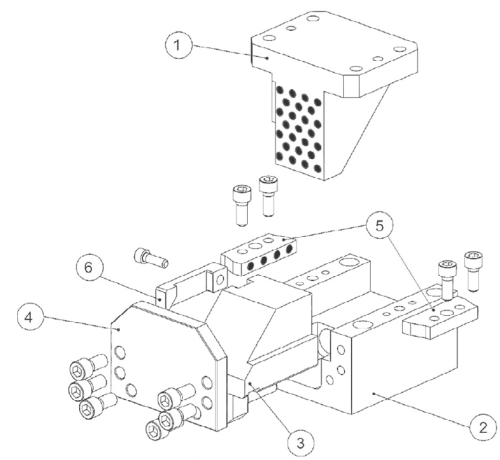
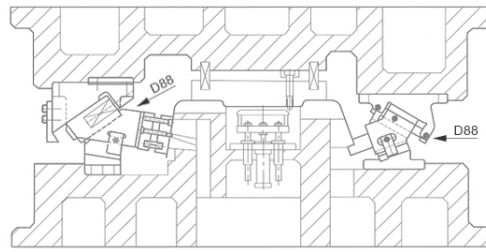

No	Parça Adı	Ad.	Malzeme	Not
1	Üst Gövde	1	SO#50F	Grafitli Yüzey
2	Alt Gövde	1	SO#50F	
3	Sürücü	1	SO#50F	
4	Arka Kapak	1	Çelik 55-60 HRC	
5	Üst Yan Kapak	2	Çelik	Grafitli Yüzey
6	Yan Klavuz Kol	1	Çelik 55-60 HRC	

Sip. No.	Yay Ölçüleri		İlk Durum Initial		Final		Zimba Alanı B x H (mm)	Maksimum Çalışma Gücü (kN)	Kurs (mm)	Ağırlık (Kg)
	Ø Yay O.D. (mm)	Serbest Boy (mm)	Uzunluk (mm)	Yükleme (N)	Uzunluk (mm)	Yükleme (N)				
D88_05225	20	70	62	150	37	600	52x65	10	25	8
D88_05240	20	100	92	100	52	610	52x65	10	40	8
D88_05260	20	150	137	110	77	620	52x65	10	60	11
D88_06540	22	100	92	130	52	770	65x70	18	40	15
D88_06560	22	150	137	130	77	770	65x70	18	60	19
D88_10040	27	100	92	190	52	1150	100x100	30	40	32
D88_10060	27	150	137	210	77	1170	100x100	30	60	33
D88_10080	30	200	188	173	108	1325	100x100	30	80	38
D88_15040	35	100	92	320	52	1880	150x100	60	40	53
D88_15060	35	150	137	340	77	1900	150x100	60	60	57
D88_20040	35	100	92	470	52	2820	200x110	80	40	71
D88_20060	35	150	137	510	77	2850	200x110	80	60	76
D88_25040	40	100	92	620	52	3690	250x130	100	40	97
D88_25060	40	150	137	660	77	3720	250x130	100	60	105
D88_30040	40	100	92	620	52	3690	300x130	130	40	113
D88_30060	40	150	137	660	77	3720	300x130	130	60	120
D88_40060	60	150	148	156	88	4760	400x150	140	60	202
D88_50060	60	150	148	310	88	9520	500x150	140	60	236
D88_60060	60	150	148	310	88	9520	600x150	140	60	269