

MK TARAMA MALAFALARI-ÇEKTİRMELİ

DIN 228 FORM A

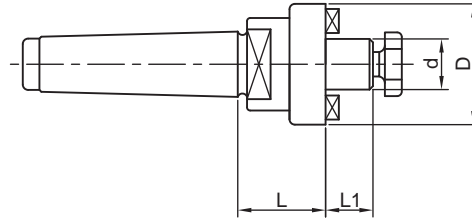

DIN 2207

ISO 3937

- MALZEME: 20 Mn Cr5
- SERTLİK: 58 ± 2 HRc (Derinlik 0,6-0,9 mm)
- AÇI: DIN 7178-1/AT3
- SALGI: MAX. 0,006 mm

SİP. NR.	KONİK	d (mm)	D (mm)	L (mm)	L1 (mm)	FİYAT KODU
MK3.C.16.T	MK3	16	40	40	17	00778
MK3.C.22.T	MK3	22	50	40	19	00779
MK3.C.27.T	MK3	27	60	45	21	00780
MK3.C.32.T	MK3	32	78	45	24	00781
MK4.C.16.T	MK4	16	40	40	17	00782
MK4.C.22.T	MK4	22	50	45	19	00783
MK4.C.27.T	MK4	27	60	50	21	00784
MK4.C.32.T	MK4	32	78	50	24	00785
MK4.C.40.T	MK4	40	88	55	27	00786
MK5.C.16.T	MK5	16	40	50	17	00787
MK5.C.22.T	MK5	22	50	55	19	00788
MK5.C.27.T	MK5	27	60	55	21	00789
MK5.C.32.T	MK5	32	78	60	24	00790
MK5.C.40.T	MK5	40	88	60	27	00791

MK TARAMA MALAFALARI-KAMALI

DIN 228 FORM B

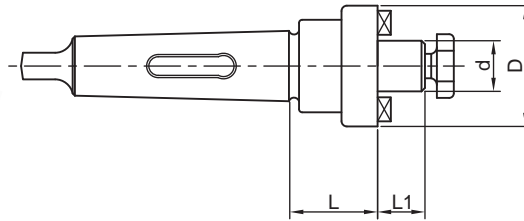

DIN 1806

ISO 3937

- MALZEME: 20 Mn Cr5
- SERTLİK: 58 ± 2 HRc (Derinlik 0,6-0,9 mm)
- AÇI: DIN 7178-1/AT3
- SALGI: MAX. 0,006 mm

SİP. NR.	KONİK	d (mm)	D (mm)	L (mm)	L1 (mm)	FİYAT KODU
MK4.K.16.T	MK4	16	40	40	17	00792
MK4.K.22.T	MK4	22	50	40	19	00793
MK4.K.27.T	MK4	27	60	50	21	00794
MK4.K.32.T	MK4	32	78	50	24	00795
MK4.K.40.T	MK4	40	88	50	27	00796
MK5.K.16.T	MK5	16	40	50	17	00797
MK5.K.22.T	MK5	22	50	50	19	00798
MK5.K.27.T	MK5	27	60	55	21	00799
MK5.K.32.T	MK5	32	78	60	24	00800
MK5.K.40.T	MK5	40	88	60	27	00801